

Kapittel 4

Jernvarer / Hardware



Jernvarer / Hardware

Kjetting / Chain

Fram Alloy Blue kjetting er laget av høyverdi stål, og leveres med sertifikat.

Kjettingen har full belastningsevne emmlom +250°C og -60°C.

Kjettingen **må ikke varmebehandles**.

Til løfteredskaper er det **kun** kortlenket kjetting som er godkjent.

Fram Alloy Blue chain is made of high-grade steel. Delivered with a certificate.

The chain must **not** be heat-treated.

Løkker, ringer og løftehodets SWL/WLL bestemmes ut fra deformasjonsgrensen, **ikke** fra min. bruddlast.

ALLOY Kortlenket / Short link

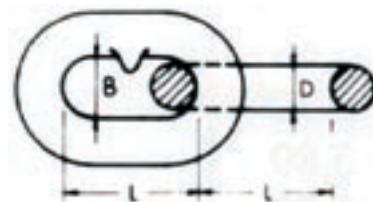

Art nr	Dimensjon i mm	SWL Sikkerhets / safety- faktor 4:1	Min. bruddlast breaking strength i tonn/tonnes	Vekt / weight i kg. pr. metre	Mål i mm Dimensions in mm		
					D	L	B
756007	7 x 21	1,5	6,0	1,05	7	21	10,3
756008	8 x 24	2m0	8,0	1,33	8	24	11,4
756010	10 x 30	3,2	12,8	2,17	10	30	14,0
756013	13 x 39	5,4	21,6	3,83	13	39	18,2
756016	16 x 48	8,0	32,0	5,78	16	48	22,4
756020	20 x 60	12,5	50,0	8,60	20	60	28,0
756022	22 x 66	15,5	62,0	10,15	22	66	29,0
756025	25 x 75	20,0	80,0	13,20	25	75	33,0
756032	32 x 96	32,0	128,0	23,00	32	96	42,0

ALLOY Halvlanglenket / Medium link

Art nr	Dimensjon i mm	SWL Sikkerhets / safety- faktor 4:1	Min. bruddlast breaking strength i tonn / tonnes	Vekt / weight i kg. pr. metre	Mål i mm Dimensions in mm		
					D	L	B1
756113	13 x 50	6,5	23,5	3,4	13	50	18
756115	16 x 65	10,0	35,0	5,1	16	65	28
756119	19 x 75	15,0	54,0	7,1	19	75	28
756122	22 x 88	20	65,0	9,3	22	88	30

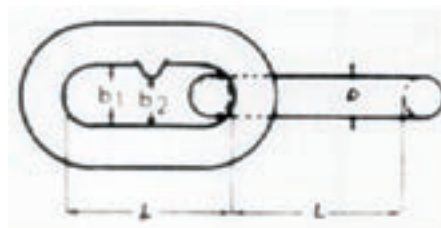

ALLOY Langlenket / Long link

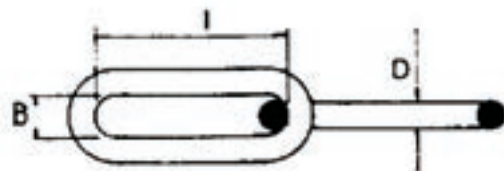

Art nr	Dimensjon i mm	SWL Sikkerhets / safety- faktor 4:1	Min. bruddlast breaking strength i tonn / ton	Vekt / weight i kg. pr. metre	Mål i mm Dimensions in mm		
					D	L	B1
756209	9 x 57	3,0	11,3	1,40	9	57	16,0
756211	11 x 66	4,5	16,6	2,10	11	66	18,0
756213	13 x 81	6,5	23,5	2,75	13	81	22,0
756216	16 x 100	10,0	35,0	4,40	16	100	26,0
756219	19 x 100	15	50,0	6,5	19	100	28,0
756222	22 x 120	18	65,0	8,5	22	120	32,0
756225	25 x 140	21,6	72,0	11,0	25	140	41,0
756228	28 x 150	29,4	98,0	14,0	28	150	39,0

ALLOY Langlenket kjetting galv. / Long link chain galvanised

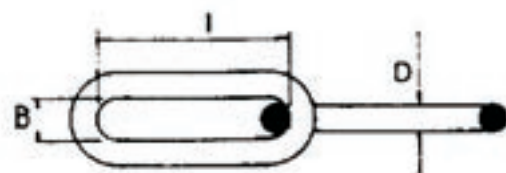

Art nr	Dimensjon i mm	Min. bruddlast breaking strength	Vekt / weight i kg. pr. i tonn / ton	D	L	B1
756611	11 x 66	12,4	2,1	11	66	18
756613	13 x 81	16,5	2,7	13	81	22
756616	16 x 100	25,0	4,4	16	100	26
756619	19 x 100	37,0	6,5	19	100	28
756622	22 x 120	52,0	8,5	22	120	32
756625	25 x 140	57,6	11,0	25	140	41
756628	28 x 150	78,5	14,0	28	150	

ALLOY Kortlenket kjetting varmgalv. / Chain, short linked, galv.

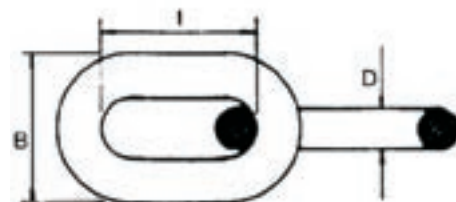

Art nr	Diam. (mm)	l (mm)	b (mm)	Ca. kg. pr m.	Min. bruddl i kg	M pr. sekk
756806	6	24	22	0,90	2200	30
756808	8	25,5	27	1,35	2500	50
756810	10	32	33	2,10	4000	30
756811	11	35	38	2,55	5000	30
756813	13	39	44	3,70	6400	30
756816	16	48	55	5,70	10000	30
756819	19	57	65	8,24	15000	30

Langlenket kjetting varmgalv. / Chain, long linked, galv.

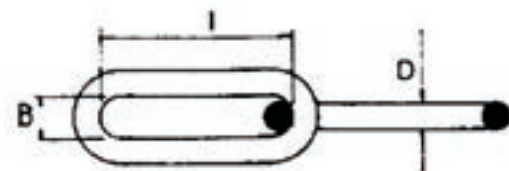

Art nr	Diam. (d)	l	b	Ca. kg. pr m.	Min. bruddl	M pr. sekk
756906	6	42	12	0,63	1400	50
756908	8	54	16	1,10	2500	50
756910	10	66	20	1,55	4000	30
756911	11	73	20	2,20	5000	30
756913	13	82	24	3,00	6400	30
756916	16	100	28	4,45	10000	30

Rustfri/syrefast kjetting SF316 / Chain, stainless steel SF316

Art nr	Diameter mm	Type	Mtr. pr sekk
756704	4	Kortlenket	30
756706	6	Kortlenket	30
756708	8	Kortlenket	30
756710	10	Kortlenket	20
756713	13	Kortlenket	30
756718	8	Langlenket	20



Kjetting for snurrevad / Chain for Danish seine

Art nr	Betegnelse / Type	Tyngde / Weight kg	Lengde / Length
S389813	Kjettingstamper 13 mm	6	1,6 mtr
S389816	Kjettingstamper 16 mm	5	18 løkker
756908	Kjetting 8 mm lang lø. galv.	1,1	pr. mtr.
756910	Kjetting 10 mm lang lø. galv.	1,55	pr. mtr.
756913	Kjetting 13 mm lang lø. galv.	3	pr. mtr.
756916	Kjetting 16 mm lang lø. galv.	4,4	pr. mtr.



Ved forhåndsbestilling kan det leveres ønsket kg pr kjetting.

Koblingsløkker / Links

B-løkker ovale / Master link

Art nr	Betegnelse / type	SWL/WWL 4:1 tonn safety-	Vekt / weight i kg	Mål i mm Dimensions in mm		
				d	B	L
757501	11 b 4	2,1	0,2	11	40	83
757502	13 B 5	2,6	0,3	13	54	86
757503	13 B 6	2,4	0,4	13	60	115
757504	16 B 6	3,8	0,6	16	70	120
757505	16 B 7	2,8	0,9	16	100	190
757506	20 B 6	6,4	1,1	20	80	134
757507	20 B 7	5,8	1,3	20	90	170
757508	22 B 6	7,6	1,6	22	90	170
757509	22 b 7	6,4	1,9	22	110	210
757510	25 B 6	10,0	2,3	25	100	190
757511	28 B 6	12,7	3,2	28	110	210
757514	38 B 6	25,0	7,5	38	140	270
757520	45 B 6	34,0	12,5	45	170	320

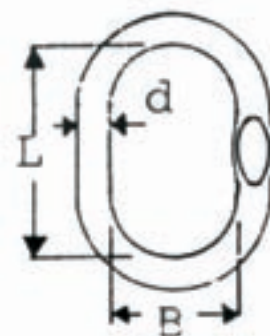

Ringer / Rings

Art nr	Betegnelse / type	SWL/WWL 4:1 tonn safety-	Vekt / weight i kg	Mål i mm Dimensions in mm	
				d	D
757413	13 O 6	1,6	0,4	13	95
757425	25 O 6	6,9	2,3	25	155
757428	28 O 6	8,6	3,2	28	175
757433	32 O 6	10,2	5,3	32	225

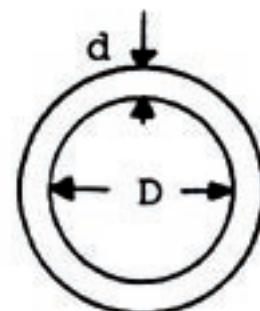

Løftehoder / Links

Art nr	Betegnelse / type	SWL/WWL 4:1 tonn	Vekt / weight	Toppløkke / toplink		Balanseløkke / balance link	
				Betegn.	Mål i mm	Betegn.	Mål i mm
757525	Q 16 B	3,8	1,2	16 B 6	70 x 120	13 B 5	54 x 86
757526	Q 20 B	5,8	1,5	20 B 7	90 x 170	16 B 6	70 x 120
757527	Q 22 B	7,6	3,8	22 B 6	90 x 170	20 B 6	80 x 134
757528	Q 25 B	10,0	4,5	25 B 6	100 x 190	20 B 6	80 x 134
757529	Q 28 B	12,7	6,4	28 B 6	110 x 210	22 B 6	90 x 170

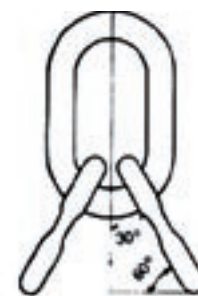

Omega koblingsløkker / Links

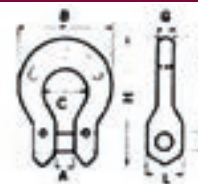

Art nr	Betegn. / type	SWL 4,5:1 tonn	SWL 4:1 tonn	Mål i mm / dimensions in mm									Vekt / weight i kg
				A	B	C	D	E	F	G	H	L	
757308	Omega 8	1,8	2,0	9,5	51	23	9,5	32	17	9	66	20	0,15
757311	Omega 11	3,3	3,8	12,5	65	30	13,0	39	22	12	84	25	0,35
757313	Omega 13	4,7	5,4	15,5	84	38	16,0	54	27	15	110	32	0,70
757316	Omega 16	7,2	8,0	19,0	102	48	20,0	64	32	20	132	40	1,25
757320	Omega 20	11,2	12,5	22,5	118	58	25,0	73	36	23	152	50	2,25

Alloy leddet koplingsløyke (GM-løyke) / GM connectors

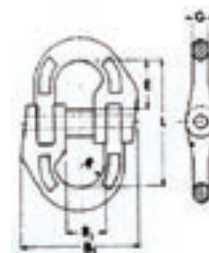

Art nr	Betegn. / type	SWL 4,5:1 tonn	SWL 4:1 tonn	For kjett. / Chain dim.	Mål i mm / dimensions in mm								Vekt / weight i kg
					L	B1	B2	E	G	M	N	R	
757107	Gm 7-8	1,8	2,0	7-8	57,5	19,5	54,5	22,0	9,0	14,5	7,2	12,5	0,2
757110	GM 10	3,3	3,8	10	68,0	25,5	68,0	26,0	11,0	17,8	8,45	15,0	0,3
757113	GM 13	4,7	5,4	13	84,5	28,0	78,0	31,0	15,8	23,5	10,9	16,0	0,6
757116	GM 16	7,2	8,0	16	102,0	33,0	97,0	39,0	19,8	26,5	14,1	19,0	1,9
757119	GM 19	11,2	12,5	20	122,0	41,5	117,0	46,0	22,0	33,0	18,2	22,0	1,7
757122	SY 22	14,8	15,5	22	141,5	53,0	138,5	54,5	22,5	37,8	22,2	32,5	2,7
757125	SY 25	18,0	20,0	25	150,0	58,0	163,5	56,0	29,5	40,5	26,2	30,0	4,3
757132	SY 32	29,0	32,0	32	173,0	67,5	198,0	64,5	37,0	54,5	36,2	40,0	7,9

Bolt og fjær for TL-Lås lagerføres i alle dimensjoner.
Spare parts for TL-connectors in stock, all dimensions.

Alloy leddet koplingsløyke (TL-løyke) / TL connectors

Art nr	Betegn. / type	WLL tonn	For kjett. / Chain dim.	Mål i mm / dimensions in mm								Vekt / weight i kg	
				L	B1	B2	E	G	M	N	R		
755573	TL-10	3,2	10-11	64	19,2	63		13					0,36
755576	TL-13	5,4	13	85	26,5	84		17					0,66
755579	TL-16	8,0	16	1+6	32,0	95		19					1,08
755582	TL-19	11,5	20	122	38,5	114		23					1,77
755583	TL-23	16,9	22	150	49,0	140		28					2,80
755586	TL-26	21,6	25	166	57,0	160		32					4,40
755590	TL-32	32,0	32	200	63,0	209		39					8,40

Bolt og fjær for TL-Lås lagerføres i alle dimensjoner.
Spare parts for TL-connectors in stock, all dimensions.



Alloy leddet koplingsløkke silver / SILVER connectors

Art nr	Betegnelse / Type	Str/ size mm	SWL 5:1 tonn	B1	B2	EG
75710607	SLC 7	7	1,6	18,1		
75710610	SLC 10	10	3,2	24,9		
75710613	SLC 13	13	5,4	31		
75710616	SLC 16	16	8,0	38,3		
75710620	SLC 20	20	12,7	48,7		
75710622	SLC 22	22	18,4	52,5		
75710626	SLC 26	26	21,2			



Bolt og fjær for SILVER-Lås lagerføres i alle dimensjoner.
Spare parts for SILVER-connectors in stock, all dimensions.

Koplingsløkke silver med svivel / SILVER connectors with swivel

Art nr	Betegnelse / Type	Str/ size mm	SWL 5:1 tonn	Mål i mm / dimesions in mm		
				a	b	d
	SLC/S 10	10	3,2	25	140	65
	SLC/S 13	13	5,4	30	200	90
751116	SLC/S 16	16	8,0	30	225	105
751120	SLC/S 20	20	12,7	47	285	120
	SLC/S 22	22	18,4	50	315	150



Silver endestykke for wire / SILVER terminal end for wire

Art nr	Betegnelse / Type	Wire dim. mm	Lås / connector mm	Vekt / weight kg
	SL-W10-C10	10	10	0,56
	SL-W12-C10	12	10	0,55
	SL-W10-C13	10	13	0,96
	SL-W12-C13	12	13	0,96
	SL-W14-C13	14	13	0,96
	SL-W16-C13	16	13	0,93
	SL-W18-C16	18	16	1,33
	SL-W20-C16	20	16	1,73
	SL-W20-C20	20	20	1,73
	SL-W22-C20	22	20	1,74
	SL-W24-C20	24	20	2,00
	SL-W26-C20	26	20	1,95
	SL-W28-C22	28	22	2,98
	SL-W30-C22	30	22	2,85
	SL-W32-C22	32	22	2,80



Art nr	Betegnelse /Type	Åpning m/m
753358	Galv. skruløkke 8 mm	11
753360	Galv. skruløkke 10 mm	20
753363	Galv. skruløkke 12 mm	23

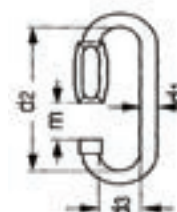

Framlok

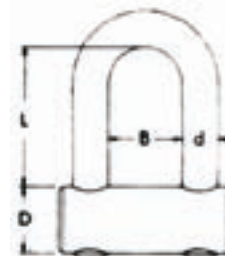

Art nr	Betegn. / type	SWL/WWL 4,5:1 tonn	For 4:1 tonn	Vekt / kjetting / weight i kg	Mål i mm / dimensions in mm				
					d	D	B	L	
757323	3	1,8	2,0	7-8	0,1	8	15	15	28
757324	4	1,8	2,0	7-8	0,1	8	15	19	33
757326	6	2,8	3,2	7-8-10	0,2	10	22	21	37
757327	7	3,3	3,8	8-10-11	0,2	11	22	19	36
757329	9	4,7	5,4	10-11-13	0,4	13	25	24	45

Harpesjakkell red-pin / Red-pin bow shackles

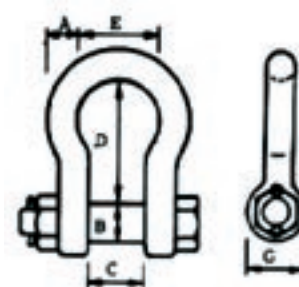

Art nr	Betegn. / type	SWL/WWL 6:1 tonn	Vekt / weight i kg	Mål i mm / dimensions in mm					
				A	B	C	D	E	G
75720098	3/8"	1,00	0,17	9	11	16	36	26	22
75720099	7/16"	1,50	0,23	11	13	18	43	29	26
757201	1/2"	2,00	0,3	13	16	21	47	33	30
757202	5/8"	3,25	0,6	16	19	27	60	42	40
757203	3/4"	4,75	1,1	19	22	32	71	51	46
757204	7/8"	6,50	1,6	22	24	37	84	58	50
757205	1"	8,50	2,3	25	28	43	95	68	58
757206	1 1/8"	9,50	3,1	28	32	46	118	74	64
757207	1 1/4"	12,00	4,4	32	35	52	119	83	72
757208	1 3/8"	13,50	6,3	35	38	57	132	89	75
757209	1 1/2"	17,00	8,0	38	42	60	146	98	86
757210	1 3/3"	25,00	14,0	44	50	73	178	127	110
757211	2"	35,00	19,0	51	58	83	197	146	127

Sjakkell kort type, øyebolt – type A / Short type shackle, screw collar pin, type A

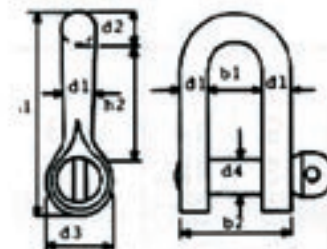

Art nr	Betegn. / type	SWL/WWL 6:1 tonn	Vekt / weight i kg	Mål i mm / dimensions in mm							
				b1	b2	d1	d2	d3	d4	h1	h2
757250	A.06.A	2,5	0,2	19	40	10	13	27	12	74	42
757251	A.1.A	4,5	0,4	23	50	13	15	35	16	90	51
757252	A.2.A	6,0	1,0	33	71	19	21	46	22	126	70
757253	A.3.A	10,0	2,2	42	89	24	26	60	27	160	85
757255	A.5.A	15,0	4,0	48	110	30	33	70	33	193	105
757256	A.6.A	25,0	5,5	54	126	34	38	78	39	220	115

Sjakkell kort type, sporbolt – type B / Short type shackle, countersunk head-on-pin, type B

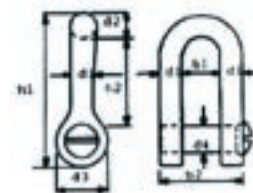

Art nr	Betegn. / type	SWL/WWL 6:1 tonn	Vekt / weight i kg	Mål i mm / dimensions in mm							
				b1	b2	d1	d2	d3	d4	h1	h2
757260	A.06.A	2,5	0,2	19	40	10	13	27	12	74	42
757261	A.1.B	4,5	0,4	23	50	13	15	35	16	90	51
757262	A.2.B	6,0	1,0	33	71	19	21	46	22	126	70
757263	A.3.B	10,0	2,2	42	89	24	26	60	27	160	85
757265	A.5.A	15,0	4,0	48	110	30	33	70	33	193	105

Sjakkell kort mutterb – type C / Short type shackle, square head pin, type C

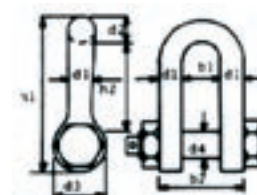

Art nr	Betegn. / type	SWL/WWL 6:1 tonn	Vekt / weight i kg	Mål i mm / dimensions in mm							
				b1	b2	d1	d2	d3	d4	h1	h2
757270	A.06.C	2,5	0,2	19	40	10	13	27	12	74	42
757272	A.2.C	6,0	1,0	33	71	19	21	46	22	126	70
757273	A.3.C	10,0	2,2	42	9	24	26	60	27	160	85
757275	A.5.C	15,0	4,0	48	110	30	33	70	33	193	105
757276	A.6.C	25,0	5,5	54	126	34	38	78	39	220	115

Slavekrok / Sling hook type SK

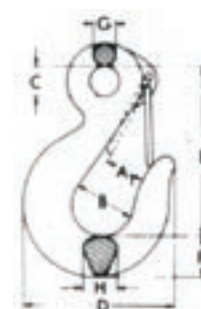

Art nr	Betegn. / type	SWL 4,5:1 tonn	SWL 4:1 tonn	Vekt / weight i kg	Mål i mm / dimensions in mm							
					a1	b	c	d	e	f	g	h
757641	SK-41	2,2	2,5	0,5	27	35	23	87	95	35	14	20
757642	SK-42	3,8	4,3	1,0	34	46	26	110	120	37	17	26
757643	SK-43	5,5	6,2	2,0	42	56	31	135	140	47	22	30
757644	SK-44	7,5	8,5	2,8	47	65	33	155	166	56	26	36
757645	SK-45	11,2	12,5	5,5	58	73	39	185	193	70	30	46

Fjær for SK-kroker / Spare parts for sling hook



Art nr	Betegn. / type
757651	SK-41
757652	SK-42
757653	SK-43
757654	SK-44
757655	SK-45

Slavekrok / Sling hook

Art nr	Betegn. / type	WLL 4,0:1 tonn	Vekt / weight i kg	Mål i mm / dimensions in mm						
				a	b	c	h	l	g	h
757639	5/6	1,10	0,30	9	20	24	16,5	108,0		
757640	7/8	2,00	0,50	11	25	30	19,5	132,5		
75764010	10	3,15	1,04	15	38	34	20,0	167,5		
75764013	13	5,30	2,15	19	43	39	31,0	213,5		

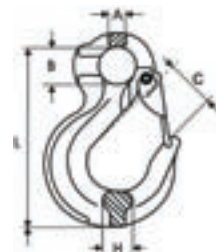

Selvlukkende krok med øye – type CL / Safety hook – type CL

Art nr	Betegn. / type	Kjt. / chain dim.	SWL 4:1 tonn	Vekt / weight i kg	Mål i mm / dimensions in mm								
					b	c	d	e	f1	f2	g	h	i
757661	CL-6-8	5-6	1,12	0,5	30	74	34	23	10	10	15	24	109
757662	CL-7/8	7-8	2,0	0,75	38	88	44	29	11	15	18	26	134
757664	CL-10	10-11	3,15	1,5	44	107	53	34	13	16	25	33	167
757666	CL-13	13	5,3	3,2	50	137	70	45	17	22	32	42	201
757668	CL-16	16	8,0	6,1	66	173	87	58	20	28	37	47	253
757673	CL-18/20	20	12,5	7,6	80	190	99	64	21	28	40	53	274



Selvlukkende krok med svivel – type CLT / Safety hook with ball bearing – type CLT

Art nr	Betegn. / type	Kjt. / chain dim.	SWL 4:1 tonn	Vekt / weight i kg	Mål i mm / dimensions in mm								
					b	c	d	f	g	h	i	m	
757691	CLT-5/6-8	5-6	0,9	1,0	0,59	29	70	34	10	17	22	145	29
757693	CLT-7/8	7-8	1,8	2,0	1,1	37	87	45	13	28	26	181	38
757694	CLT-10	10-11	3,3	3,8	2,0	46	107	56	16	36	35	220	45
757696	CLT-13	13	4,7	5,4	3,8	60	140	70	19	40	45	270	51
757698	CLT-16	16	7,2	8,0	7,4	75	165	80	25	52	60	315	60
	CLT-18/20	20	11,2	12,5	11,7	78	196	102	30	52	60	460	75



Innkortingskrok / Grab hook

Art nr	Betegn. / type	Kjt. / chain dim.	SWL 4,5:1 tonn	SWL 4:1 tonn	Vekt / weight i kg	Mål i mm / dimensions in mm						
						a	c	d	e	f	g	h
757708	G 8	7-8	1,8	2,0	0,6	10	19	55	80	30	13	30
757711	G 11	10-11	3,3	3,8	1,2	14	27	68	100	36	18	36
757713	G 13	13	4,7	5,4	1,7	16	29	80	120	40	20	40
757716	g 16	16	7,2	8,0	2,9	21	35	97	150	48	24	48
757719	OKF-18/20	18/20										



Svivelkrok / Swivel hook

Art nr	Betegn. / type	SWL 5:1 tonn	Vekt / weight i kg	Mål i mm / dimensions in mm										
				a	b	c	d	e	f	g	h	i	j	k
7576602	A 702-EK	2	2,0	218	54	20	20	45	22	45	80	102	29,5	41,2
7576605	A 705-EK	5	6,3	284	70	33	30	64	33	60	97,5	123	35,8	51

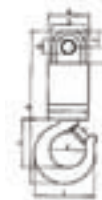

Støperikrok / Foundry hooks (Gilson hook)

Art nr	Betegn. / type	SWL 4:1 tonn	Vekt / weight i kg	Mål i mm / dimensions in mm						
				a	c	e	f	g	h	i
757761	CWH 8	2	1,1	64	18	123	30	13	26	50
	CWH 10	3,8	2,1	78	22	148	36	16	32	55
	CWH 13	5,4	3,5	89	27	175	43	20	40	70
757764	CWH 16	8	5,3	102	35	207	50	24	45	75
757765	CWH 18/20	12,5	10,6	114	40	235	67	26	60	85



Støpekrok (Gilsekrok)/Dumpekrok / Gilson hook type BS 45/Yoyo krok

Art nr	Betegn. / type	Kjt. / chain dim.	SWL 4,5:1 tonn	SWL 4:1 tonn	Vekt / weight i kg	Mål i mm / dimensions in mm					
						a	b	c	d	e	f
757745	BS 45		4,5	3,5	290	50	30	63	70	65	



Sjakler / Shackles

D-sjakler galv. med øye / D-shackles, galv. with eyepin

Art. nr.	Betegnelse/ Type	Diam. i mm (a)	innvendig lengde i mm (d)	Åpning i mm	Arb. belastning i kg
750149	3/16"	5	20	10	150
750150	1/4"	6	26	15	300
750151	5/16"	8	28	16	500
750152	3/8"	10	38	19	800
750153	7/16"	11	44	22	900
750154	1/2"	13	47	28	1000
750156	9/16"	14	60	30	1500
750157	5/8"	16	63	34	2000
750158	3/4"	20	76	40	3000
7501581	7/8"				
7501582	1"				



D-sjakler galv. med spor / D-shackles, galv. with countersunk head on pin

Art. nr.	Betegnelse/ Type	Mål i mm / dimensions in mm			SWL 5:1 tonn
		a	b	c	
750159	5/16"				
750160	3/8"	10	10	40	0,3
7501601	1/2"	12	12	48	0,5
750161	5/8"	16	16	60	0,8
750162	3/4"	19	19	74	1,1

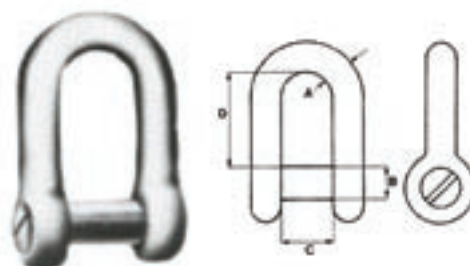

Sjakler / Shackles

Bow-sjakkell med øye galv. / Bow-shackles with eyepin, galv

Art. nr.	Betegnelse/ Type	Diam. i mm (a)	innvendig lengde i mm (d)	Åpning i mm (c)	Arb. belastning i kg
750167	1/4"	6	25	12	300
750168	5/16"	8	29	14	500
750169	3/8"	10	36	16	800
750170	7/16"				
750171	1/2"	13	45	23	1000
750172	9/16"	14			1500
750173	5/8"	16	58	30	2000
750174	3/4"	20	69	40	3000
750175	7/8"				
750176	1"				



D-sjakkell Alloy med firkantbolt / D-shackles, Alloy with square head pin

Art. nr.	Betegnelse/ Type	Dim. sjakkell i mm (A)	Dim. bolt i mm (B)	Åpning i mm (C)	Innv. lengde i mm (D)	SWL i kg
750116	1/2"	12	14	30	53	2000
750117	5/8"	16	20	32	55	3250
750118	3/4"	20	22	32	58	4750
750121	7/8"	22	25	37	74	6500
750122	1"	25	28	42	82	8500
750125	1 1/4"	32	35	51	94	12000
7501253	1 3/8"					
750126	1 1/2"	40	45	60	127	17000
750128	1 3/3"	45	50	73	178	25000
750129	2"					

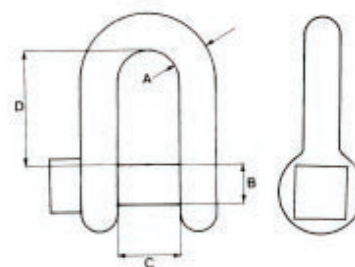

D-sjakkell Alloy med firkantbolt type red / Greenpin / D-shackle, Alloy with square

Art. nr.	Betegnelse/ Type	Dim. sjakkell i mm (A)	Dim. bolt i mm (B)	Åpning i mm (C)	Innv. lengde i mm (D)	SWL i kg
7501252	1 1/4"	32	35	51	94	12
7501262	1 1/2"	38	42	60	127	17
7501282	1 3/4"	45	50	74	149	25

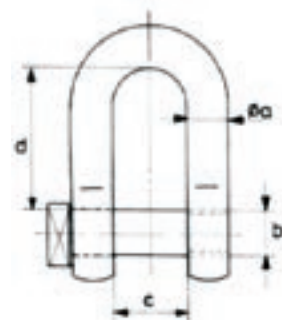

D-sjakkell Alloy med sporolt / D-shackle, Alloy with countersunk head on pin

Art. nr.	Betegnelse/ Type	Dim. sjakkell i mm (A)	Dim. bolt i mm (B)	Åpning i mm (C)	Innv. lengde i mm (D)	SWL i kg
750131	1/2"	12	14	30	53	2000
750133	5/8"	16	20	32	55	3250
750135	3/4"	20	22	32	58	4750

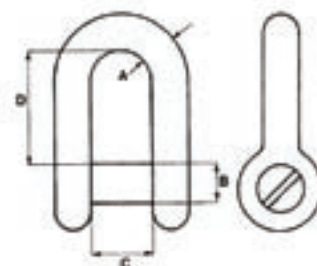

Bow-sjakkell Alloy med firkantbolt / Bow shackle, Alloy with square-head pin

Art. nr.	Betegnelse/ Type	Dim. sjakkell i mm (A)	Dim. bolt i mm (B)	Åpning i mm (C)	Innv. lengde i mm (D)	SWL i kg
750185	5/8"	16	20	32	64	3250
750186	3/4"	20	22	32	76	4750
750189	7/8"	22	25	37	83	6500
750190	1"	25	28	42	95	8500
750193	1 1/4"	32	35	51	114	12000
750194	1 1/2"	40	45	60	146	17000
7501942	1 3/4"					25000

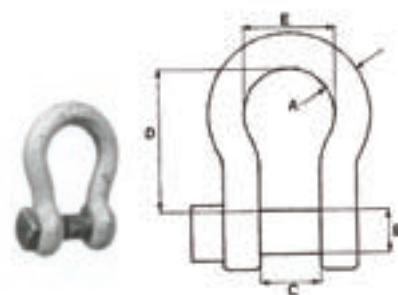

Bow-sjakkell Alloy med firkantbolt / Bow shackle, Alloy with square-head pin

Art. nr.	Betegnelse/ Type	Dim. sjakkell i mm (A)	Dim. bolt i mm (B)	Åpning i mm (C)	Innv. lengde i mm (D)	SWL i tonn
	1 1/4"	32	38	57	133	13,50
7501942	1 1/2"	38	42	60	146	17
7501962	1 3/4"	45	50	74	178	25

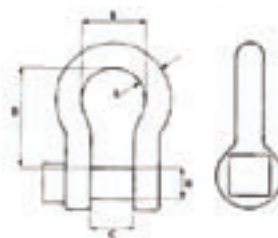
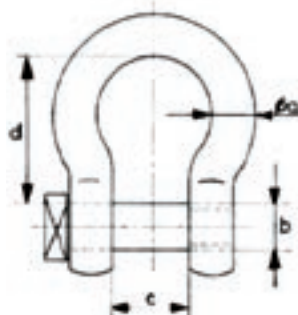

V-sjakkell Alloy med firkantbolt / V-shackle Alloy with square head pin

Art. nr.	Betegnelse/ Type	Dim. sjakkell i mm	Dim. bolt i mm (D)	Åpning i mm (C)	Innv. lengde i mm (A)	SWL 5:1 i kg (G)
750164	1 1/4"	32	32	76	110	9000

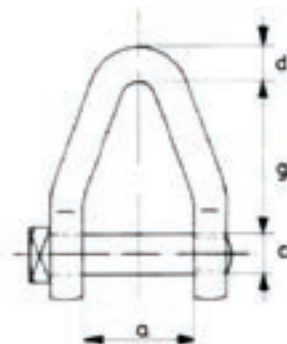

Smettløkker / Split links

Art. nr.	Betegnelse/ Type	Mål i mm / Measures in mm					Brudd- SWL last	
		A mm	B mm	C mm	D mm	E mm	tonn	tonn
753218	DL 18 S	76	44	18	15	50	1,0	0,2
753219	DI 19 S	80	51	24	19	49	2,0	0,4
753220	DI 20 S	83	56	23	18	49	3,0	0,5
753221	DL 21 S	113	65	23	24	70	7,0	1,4
753222	DL 22 S	110	74	33	23	70	6,5	1,3



Løkker / Links

Smettløkker med øye / Split links with eye

Art. nr.	Betegnelse/ Type	Mål i mm / Measures in mm					Brudd- SWL last	
		A mm	B mm	C mm	D mm	E mm	tonn	tonn
753226	DL 26 S	150	95	39	28	16	12	2,4
753227	DL 27 S	212	130	58	33	23	25	5,0
753228	DL 28 S	260	163	61	49	29	60	12,0



Briller galvanisert / Galvanized "figure of eight"

Art. nr.	Betegnelse/ Type	Ø mm	A mm	B mm
751452	CS 12	12	40	125
751456	CS 16	16	41	140

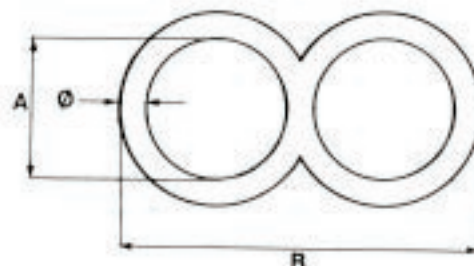

Kellys øye / Kelly's eye

Art. nr.	Str. / size / Type	SWL tonn
750601	3/4» liten	
750602	1» middels	
750603	1 1/4» stor	
750604	E 90-25	7
750605	E 90-30	12
750604	E 90-40	19
7506075	EVR 15	15
750608	EVR 20	20

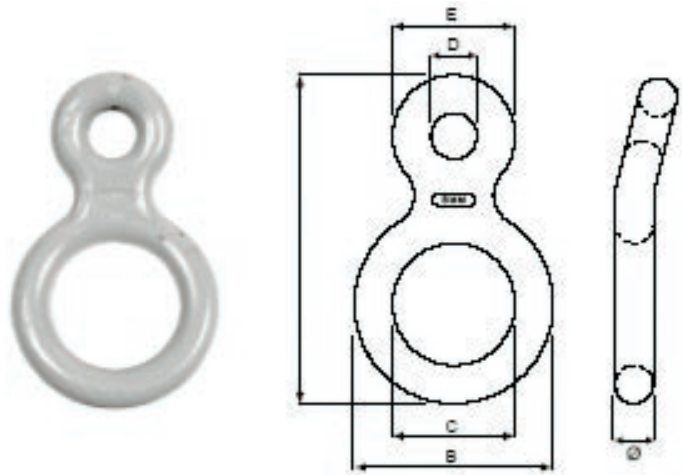

Stopper

Art. nr.	Str. / size / Type	SWL tonn
750611	3/4" liten	
750612	1" middels	
750613	1 1/4" stor	
7506153	E 90-30S	12
7506154	E 90-40S	19



G-kroker "Viking" / G-hook galvanised

Art nr	Betegn. / type	Str. / size	SWL 5:1	A	B	C	C1	D	E
750616	EVG 5	3/4"	5,0	132	82	38	38	17	26
750617	EVG 8	7/8"	8,0	153	97	42	42	18	30
750618	EVG 10	1"	10,0	180	115	40	30	20	35
750619	EVG 15	1 1/4"	15,0	215	136	50	40	18	45
750620	EVG 20	1 1/2"	20,0	240	155	60	50	27	50



Flatløkker "Viking" / Master link

Art nr	Betegn. / type	Str. / size	SWL 5:1	Ø	A	B	C	D	E
750642	EVR 8	7/8"	8,0		175	97	38	15	22
750643	EVR 10	1"	10,0		205	140	40	17	25
750645	EVM 15	1"	15,0	30	170	75	17		
750650	EVM 20	1 1/2"	20,0	34	180	85	25		



Smetteløkker "Viking" / Viking link

Art nr	Betegn. / type	SWL 5:1	A mm	B mm	C mm	D mm	E mm
753230	DV 30	3,0	115	70	42	30	2,5
753235	DV 50	5,0	130	80	42	36	2,5
7532240	DV 80	8,0	145	90	42	42	2,5

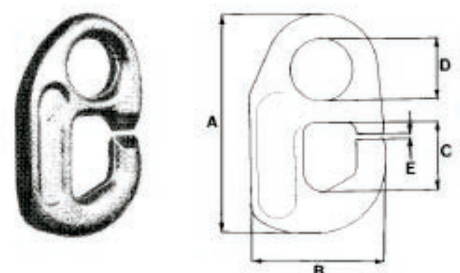

G-kroker "Cosalt" uten løkke / G-Hook without link

Art nr	Betegn. / type	Str. tommer	Str. mm	SWL 5:1
750626	HB 87	3/4"	19	2
750627	HB 86	1"	25	6
750628	HB 84	1 1/4"	32	9
750630	HB 83	1 1/2"	38	12

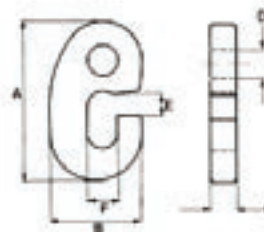

G-kroker "Cosalt" med løkke / G-Hook with link

Art nr	Betegn. / type	Str. tommer	Str. mm	SWL 5:1
750621	HB 87	3/4"	19	2
750622	HB 86	1"	25	6



Flatløkker "Cosalt" / Master link

Art nr	Betegn. / type	Str. size	Str. size mm	SWL 5:1
750631	HL 242	3/4"	19	2
750632	HL 241	1"	25	4
750634	HL 112	1 1/4"	32	8
750636	HL 239	1 1/2"	38	12

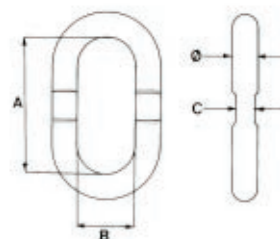

Svivler type A-stål / Swivels type A steel

Art nr	Lengde / length	Type	SWL
	220	A 405	5
751108	250	A 408	8
751110	295	A 412	12
751112	360	A 417	17
751114	435	A 422	22



Svivler med ledd rustfri / Stainless steel swivels

Art nr	Str.	Ø mm	A mm	B mm	C mm	D mm	E mm	SWL 5:1
751126	7/8"	22	44	40	40	55	255	6,3
751127	1"	25	55	50	45	70	320	8,3
751128	1 1/4"	32	55	55	54	93	360	12,0
751130	1 1/2"	38	62	58	60	110	410	18,0
7511302	1 3/3"	45	75	70	70	115	515	28,0

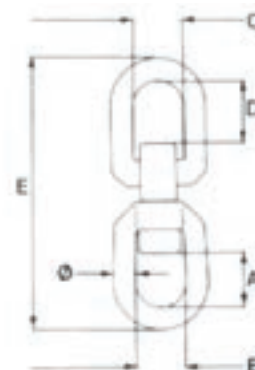

Svivler type A rustfri / Stainless steel swivels type A

Art nr	Str.	Ø mm	A mm	B mm	C mm	D mm	E mm	SWL 5:1
751131	1/2"	13	29	28	27	30	140	1,6
751132	5/8"	16	43	38	35	47	180	3,2
751133	3/4"	19	45	39	38	63	230	4,7
751134	7/8"	22	45	40	40	42	222	6,3
751135	1"	25	52	50	42	52	278	8,3
751138	1 1/4"	32	60	50	50	98	350	12,0
751140	1 1/2"	38	72	58	58	112	390	18,0

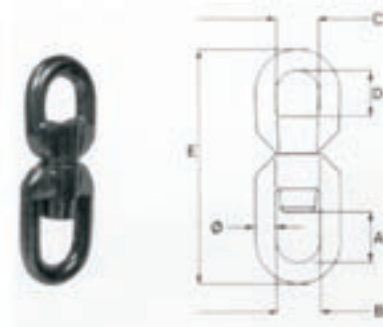

Diverse / Misc.

Notbly åpne / lukkete / Lead weights

Art nr	Tekst
S903026	Bly brukt
S903050	Bly 500 gr
S903051	Bly brukt 500 gr
S903052	Bly 500 gr åpne
S903100	Bly 1000 gr
S903101	Bly brukt 1000 gr
S903102	Bly 1000 gr åpne
S903151	Bly brukt 1500 gr



Snurperinger / Net rings

Art nr	Tekst
S753370	Snurpering Boss 90SR
S753371	Snurpering Boss 80 SR
S753373	Snurpering Boss 50 SR
S753374	Snurpering Boss 40 SR
S753375	Snurpering rulle BO 40-50-90 R
S753378	Snurpering plugg+fjær 40-50 SR
S753380	Snurpering plugg+fjær 90 SR
S753390	Snurpering Boss 10 S (Karabin)
S753391	Snurpering messinghylse Bos 10 S
S753392	Snurpering fjær Boss 10 S

Slepesett med flatløkke / Combination with master link

Art nr	Dim.
750701	3/4"
750703	7/8"
750716	1"



Slepesett uten flatløkke / Combination without master link

Art nr	Dim.
750715	1"
750717	1 1/8"
750718	1 1/4"

Krokodillenøkler / Spanner

Art nr	Str. / size	Enkel/ dobbelskjeftet
750802	12"	dobbel
750806	19"	enkel
750808	27"	enkel



Dumpekrok / Yo-yo hook

Art nr	Str. / size	Betegnelse / type	SWL 5:1 tonn
750812	1 1/4"	YO-YO	
750813	1 1/2"	YO-YO	
7507745	375 mm	BS 45	4,5



Merlespiker / Marline Spikes for wire

Art nr	Betegnelse / type	Lengde / length	Rustfri / stainless
751513	EM 260 SS	10"	x
751514	EM 350 SS	14"	x
751504	EM 350	14"	
751506	EM 450	18"	
751508	EM 510	20"	
751510	EM 700	28"	

Art nr	Betegnelse / type	A (length)	B
751515	Plastskaft / plastic shaft	305	33
751516	Plastskaft / plastic shaft	385	43
751517	Treskaft / wooden shaft	170	
751518	Treskaft / wooden shaft	280	

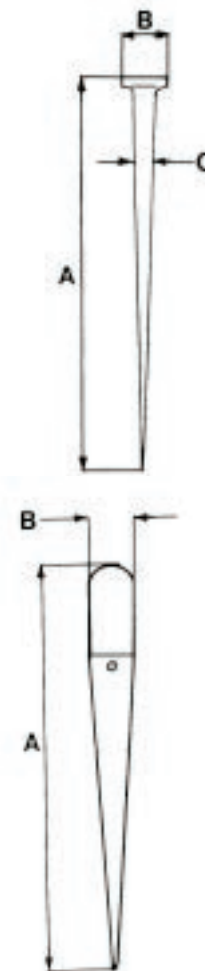

Wiresaks "HIT" / Wire cutters "HIT"

Art nr	Betegnelsen / type	Wire Ø max mm	Lengde / length mm	Vekt / weight kg
751654	HC 12	12	520	1,50
751656	HC 16	16	650	2,50

Reservedeler som blad og bolter kan skaffes.
Spare parts such as blades and bolts can be supplied.



Dor / Punches

Art nr	Str. / size i mm	A	B	C	D	For lås / connectors nr.
755682	5	150	45	5	10	7
755683	7	190	70	7	22	10
755684	9	210	85	9	22	13
755685	11	220	100	11	22	16
755686	13	240	115	13	22	19
755687	15	250	125	15	22	22

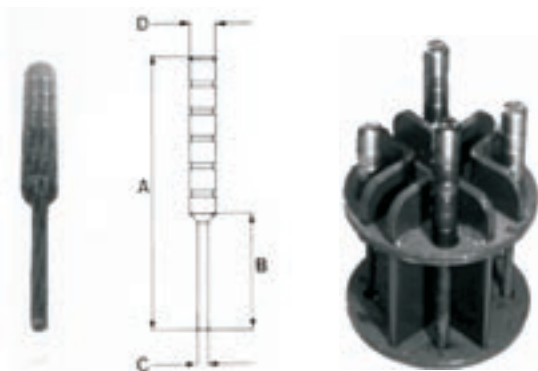

Stativ for dor / Rack for Punches

Art nr	Betegnelsen / type	Kjetting / chain dim.
755680	E600	
755675	E650	13 - 16
755676	E650	19 - 22

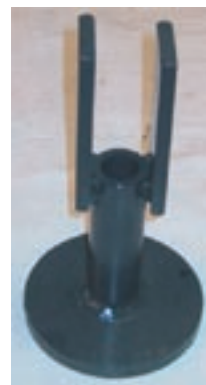

Spleisestikke / Wire vice

Art nr	Betegnelsen / type	Kjetting / chain dim.
751701	E 122	Liten / small
751702	E 134	Stor / large
751704	Spindel m/ gjengeklosse	

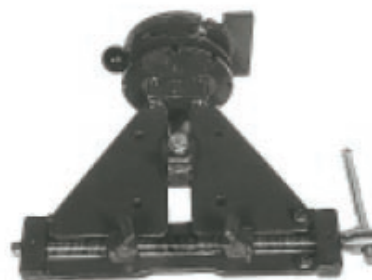

Rørstikke / Wire holder

Art nr	Betegnelsen / type
751710	E 150



Kauser for tau og wire / Hawserthimbles for rope and wire

Art nr	Str. / size	For tau / rope diam. i mm
751402	2	8
751403	2 1/4"	10
751404	2 1/2"	12
751408	3"	14
751410	3 1/2"	16
751412	4"	18
751414	4 1/2"	20
751416	5"	22
751418	5 1/2"	24
751419	6"	26
751420	6 1/2"	28
751426	7 1/2"	32
751432	9"	36
751434	10"	40
751440	12"	44

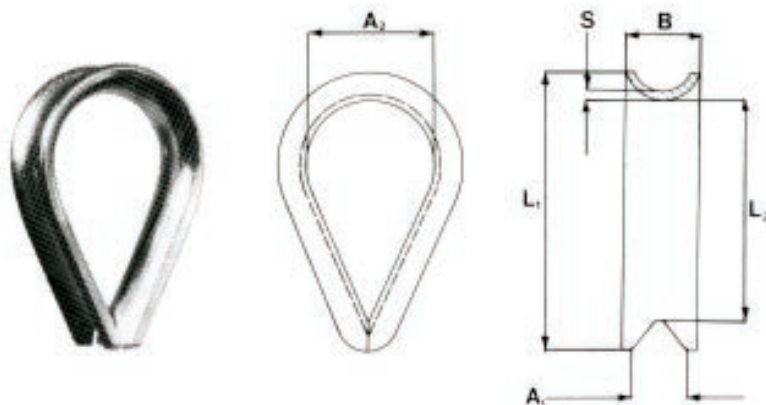

Kauser for trosser / Hawser eyelets

Art nr	Str. / size	For tau / rope diam. i mm
751384	4"	28 - 32
751385	5"	36 - 40
751386	6"	48 - 52
751387	7"	56 - 62
751388	8"	64 - 70



Wire kauser BIÅ, sveiset / Wire eyelets

Art nr	A mm	B mm	C mm	D mm	E mm	For wire / max:
751480	12	90	23	4,0	8	10mm
751481	15	105	27	5,0	10	12mm
751482	17	115	27	4,0	10	14mm
751483	19	120	32	5,0	12	16mm
751484	22	140	35	5,0	15	18mm
751485	25	180	45	6,3	16	22mm
751486	30	195	47	7,0	18	25mm
751487	35	215	60	7,0	22	32mm

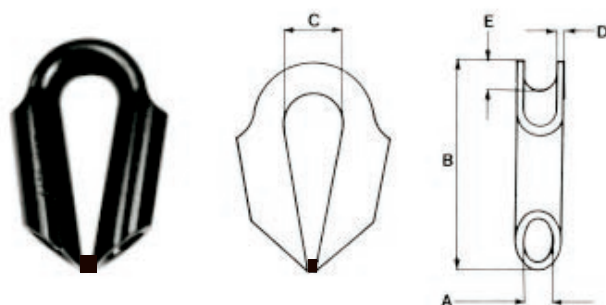

75147935 Kause-kile

Wire kauser BIÅ med kile / Wire eyelets

Art nr	A mm	B mm	C mm	D mm	E mm	For wire / max:
751474	22	140	35	5	15	18mm
751475	25	180	45	6,3	16	22mm
751476	30	195	47	7	18	24mm
751477	35	215	60	7	22	32mm



Wireklemmer galv. type U-bolt / Wire rope clips

Art nr	Dimensjon mm	Dimensjon tom. / inches	Høyde mm	Bredde mm
751297	3,5	1/8"	20	21
751299	5	3/16"	24	23
751300	6	1/4"	28	26
751301	8	5/16"	34	30
751302	10	3/8"	42	34
751304	12	1/2"	55	42
751305	14	9/16"	57	44
751306	16	5/8"	63	50
751308	19	3/4"	75	54
751310	22	7/8"	85	61
751312	26	1"	95	65
751316	34	1 1/4"	120	80
751318	40	1 1/2"	140	88

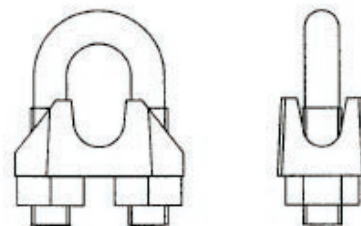

Deka-klemmer (DBL.) / Wire rope clips

– Godkjent for bruk i løfteinnretninger

Art nr	Dimensjon mm	Dimensjon tom. / inches	For wire diam.:
7513018	8	3/8"	8-9
7513022	10	7/16"	10-11
751303	12	1/2"	12
751307	16	5/8"	16
751309	20	3/4"	20
751313	21-25	1"	21-25



Strekfisker / Rigging screws

Art nr	Dim. mm	Dim. tom. / inches	Min. lengde / length	Max. lengde / length	Åpning gaffel / opening fork mm
751352	10	3/8"	190	290	11
751353	11	7/16"	240	370	12
751354	12	1/2"	285	430	13
751356	16	5/8"	370	540	16
751358	20	3/4"	425	625	20
751360	22	7/8"	480	690	25
751362	25	1"	520	740	30
751364	32	1 1/4"	630	900	33
751366	38	1 1/2"	690	980	42



Blokker / Blocks

Art nr	Betegn. / type	A mm	B mm	D mm	L mm	M mm	FN max:	SWL
754012	KSW 1-N	190	22	80	24	13	48	1,0
754013	KSW 1-S	190	22	80	24	13	48	1,0

N = nylonhjul
S = stålhjul

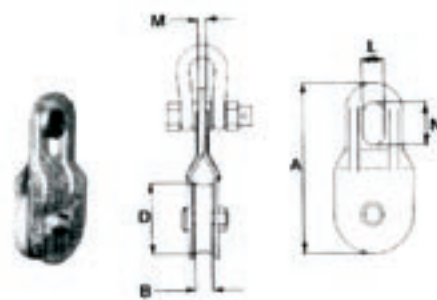

Taljeblokker av jern enkel med svivel øye / cast iron blocks (single) with swivel

Art nr	Betegn. / type	Tonn
754203	3"	0,5
754204	4"	1,0

Taljeblokker av jern dobbel med svivel øye / cast iron blocks (double) with swivel

Art nr	Betegn. / type	Tonn
754206	3"	0,5
754207	4"	1,0



Kasteblokker av jern med svivel øye / Cast iron snatch block with swivel

Art nr	Betegn. / type	Tonn
754003	3"	0,5
754004	4"	1,0
754005	5"	1,5



KT-blokker enkel / Single trio blocks

Art nr	Betegn. / type	A mm	B mm	C mm	D mm	SWL 5:1 tonn
754210	KT 1*	163	22	16	80	1,0
754221	KT 2*	195	24	22	110	2,0
754231	Kt 3*	257	28	31	150	3,0
754241	KT 4*	330	35	40	185	4,4
754261	KT 6*	365	42	40	210	6,0

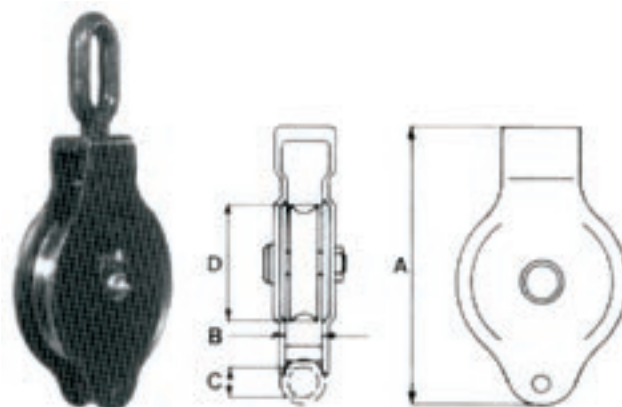

*Leveres i galv. / Also galvanized

KT-blokker dobbel / Double trio blocks

Art nr	Betegn. / type	A mm	B mm	C mm	D mm	SWL 5:1 tonn
754218	KT 1D-N*	187	22	16	80	1,0
754228	KT 2D-N*	224	24	22	110	2,0
754233	KT 3D*	296	28	31	150	3,0
	KT 4*	385	35	40	185	4,4
	KT 6*	425	42	40	210	6,0

*Leveres i galv. / Also galvanized

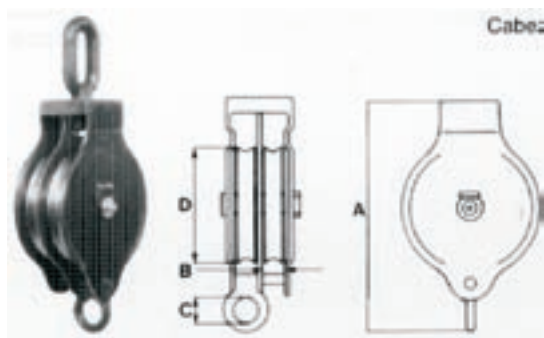

KT-blokker bred type / Tackle blocks wide size

Art nr	Betegn. / type	A mm	B mm	D mm	E mm	F mm	F1 mm	G mm	SWL 5:1
754232	KT 110*	270	85	110	128	85	145	72	3,0
754252	KT 150*	320	85	150	130	85	150	112	5,0

*Leveres galvanisert / Also galvanized.

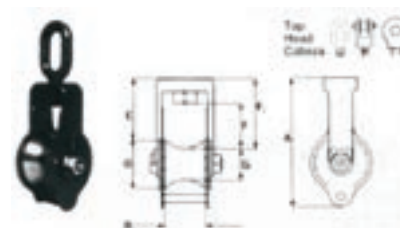

KS-blokker liten type / Small sized snatch blocks

Art nr	Betegn. / type	A mm	B mm	D mm	I mm	SWL 5:1 tonn
754021	KS 2	225	24	110	23	2,0
754031	KS 3	300	28	150	30	3,0
754041	KS 4	330	35	185	33	4,5
754061	KS 6	378	41	210	35	6,0

Leveres galvanisert / Can also be delivered galvanized.

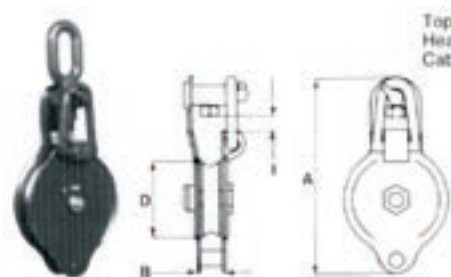

KS-blokker mellomstor type / Mid-sized snatch blocks

Art nr	Betegn. / type	A mm	B mm	D mm	E mm	I mm	SWL 5:1 tonn
754038	KS 40	250	45	110	45	38	3,5
	KS 50	325	60	150	80	60	4,6
	KS 60	375	60	215	50	50	6,0

Leveres galvanisert / Can also be delivered galvanized.

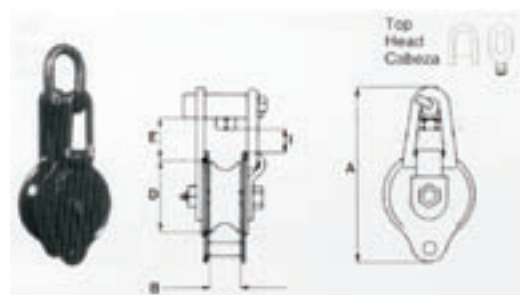

KS-blokker bred type / Wide-sized snatch blocks

Art nr	Betegn. / type	A mm	B mm	D mm	E mm	F mm	G mm	I mm	SWL 5:1 tonn
754032	KS 110	255	85	110	68	85	70	45	3,0
754052	KS 150	330	85	150	75	85	110	55	5,0

Leveres galvanisert / Can also be delivered galvanized.

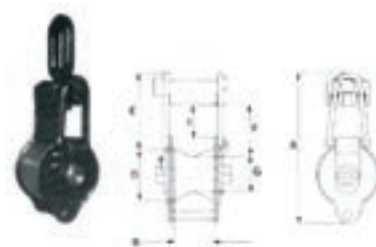

KS-blokker / Snatch blocks

Art nr	Betegn. / type	A mm	B mm	D mm	I mm	SWL 5:1
754014	KS 10 G	220	45	90	30	1,0
	KS 20	220	45	90	30	1,5
	KS 30	350	45	110	30	2,0

Leveres også galvanisert / Also available galvanized.

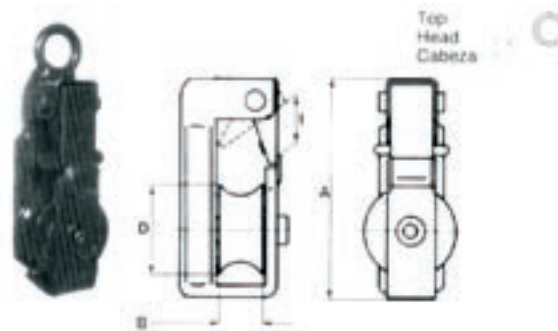

Styreblokker / Blocks

Art nr	Betegn. / type	A mm	B mm	C mm	D mm	SWL 5:1
754211	E 13 B	250	40	50	60	1,0

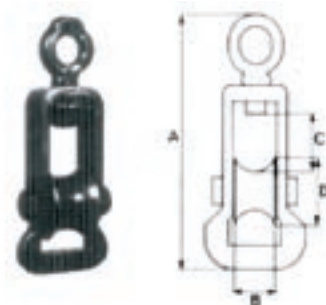

Kasteblokker / Snatch blocks

Art nr	Betegn. / type	A mm	B mm	C mm	D mm	SWL 5:1
754010		290	100	16	16	1,0
754040		482	150	28	26	4,0

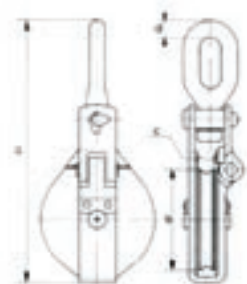

Isblokk / Snatch blocks

Art nr	Betegn. / type	A mm	B mm	C mm	D mm	SWL 5:1
754310						10 T

Kasteblokker med swivel og øye / Snatch blocks with swivel and eye

Art nr	Str. / size	Diam. hjul / wheel	Innv., diam. øye / eye	Max. arb. last kg
754506	6"	76x32	23	650
754508	8"	125x45	27	1000
754510	10"	140x57	38	1900



Treblokk dobbel med krok / Double wooden blocks with hooks

Art nr	Betegnelsen / type	Max. arb. last kg
754603	3"	200
754604	4"	300
754605	5"	400

Leveres også enkel og trippel / Also single and triple.



Løfteutstyr / Lifting tackle

Rundslings i polyester / Polyester slings

Art nr	SWL / WWL. Tonn	Omkrets / circum. metres	Arb. lengde / work length metres	Farge colour
	1	1	0,5	Fiol. / purp.
	1	2	1	Fiol. / purp.
	1	3	1,5	Fiol. / purp.
758124	1	4	2	Fiol. / purp.
758126	1	6	3	Fiol. / purp.
758128	1	8	4	Fiol. / purp.
	1	10	5	Fiol. / purp.
	1	12	6	Fiol. / purp.
758221	2	1	0,5	Grønn / green
758222	2	2	1	Grønn / green
488223	2	3	1,5	Grønn / green
758224	2	4	2	Grønn / green
758226	2	6	3	Grønn / green
758228	2	8	4	Grønn / green
	2	10	5	Grønn / green
	2	12	6	Grønn / green
	3	1	0,5	Gul / yellow
	3	2	1	Gul / Yellow
758323	3	3	1,5	Gul / Yellow
758324	3	4	2	Gul / yellow
758326	3	6	3	Gul / yellow
758328	3	8	4	Gul / yellow
	3	10	5	Gul / yellow
	3	12	6	Gul / yellow
7583516	5	6	3	Rød / red
7583518	5	8	4	Rød / red



Båndstropp i polyester / Polyester webbing strap

Art nr	SWL / WWL. Tonn	Arb. lengde / work length metres	Farge/ colour
	1	2	Fiolett / purple
	1	2	Fiolett / purple
758103	1	3	Fiolett / purple
758104	1	4	Fiolett / purple
	1	5	Fiolett / purple
758106	1	6	Fiolett / purple
758108	1	8	Fiolett / purple
	1	10	Fiolett / purple
	2	2	Grønn / green
758203	2	3	Grønn / green
758204	2	4	Grønn / green
758205	2	5	Grønn / green
758206	2	6	Grønn / green
758208	2	8	Grønn / green
758210	2	10	Grønn / green
758212	2	12	Grønn / green
	3	2	Gul / yellow
	3	3	Gul / yellow
758304	3	4	Gul / yellow
758305	3	5	Gul / yellow
758306	3	6	Gul / yellow
758308	3	8	Gul / yellow
	3	10	Gul / yellow
758312	3	12	Gul / yellow
7583508	5	8	Rød / red
7583512	5	12	Rød / red



Lastesurring / Lashing straps

Art nr	Lengde / length meter	Utførelse / design	Type
	3,5 + 0,5	med kroker / hooks	S 2 K
	4,5 + 0,5	med kroker / hooks	S 2 K
7584026	5,5 + 0,5	med kroker / hooks	S 2 K
758406	5,5 + 0,5	med kroker / hooks	S 8 K
	7,5 + 0,5	med kroker / hooks	S 8 K
758410	9,5 + 0,5	med kroker / hooks	S 8 K
758390	5,0 + 0,5	med kroker / hooks	hobby



Løfte-laste-trekk-surring / Lashing straps

Art nr	Løft / lift	Trekk / pull	Surring / lashing
758460	200 kg	500 kg	3000 kg



Diverse

Blokker / RF304 blocks

Art nr	Artikkel / type	Str. / size	Arb. last / working load i kg
754410	Blokk nylon med rustfri øye	10mm	-
754414	Blokk nylon med rustfri øye	14mm	-
754418	Blokk nylon med rustfri øye	18mm	-
7544925	Blokk rustfri, enkel	25mm	417
7544932	Blokk rustfri, enkel	32mm	417
7544950	Blokk rustfri, enkel	50mm	636
7545025	Blokk rustfri, dobbel	25mm	417
7545032	Blokk rustfri, dobbel	32mm	417
7545050	Blokk rustfri, dobbel	50mm	636



Karabinkroker standard syrefast / Acid proof carabiner Sf316

Art nr	Str. / size	innv. lengde / inside length mm	Arb. last / working load i kg
753415	5	50	143
753416	6	60	168
753417	7	70	188
753418	8	80	218
753420	10	100	288
753421	11	120	313
753422	12	140	320
753423	13	160	330



Karabinkroker med lås, syrefast / Acid proof carabiner with lock

Art nr	Godstykkelse i mm	Innvendig lengde i mm	Arb. last i kg
753478	8	80	218
753480	10	100	288
753481	11	120	313



Karabinkroker med sikring og bolt / Carabiner safety hook

Art nr	Str. / size	innv. lengde / inside length mm	Arb. last / working load i kg
753514	11	120	313



Karabinkroker med lås, syrefast / Acid proof carabiner with lock

Art nr	Str. / size	innv. lengde / inside length mm	Arb. last / working load i kg
753506	6	60	168
753508	8	80	218
753510	10	100	288
753511	11	120	313



Karabinkroker, syrefast, fransk type / French carabiner, acid proof

Art nr	Str. / size	innv. lengde / inside length mm	Arb. last / working load i kg
753407	-	70	175
753410	-	100	300



Karabinkrok med fast øye, syrefast / Acid proof carabiner with fixed eye

Art nr	Betegnelse / type
753401	Nr 1
753402	Nr 2
753403	Nr 3



Karabinkrok med sivel, syrefast / Acid proof carabiner with swivel

Art nr	Betegnelse / type
753405	Nr 2
753406	Nr 3



Rustfri løftekrok – syrefast / Acid proof lifting hook

Art nr	Betegnelse / type	Bruddlast / breaking load
757605	1 1/8 X 5"	325 Kg



Rustfri Kauser / Eyelet Stainless Steel SF 316

<i>Art nr</i>	<i>Str / size</i> <i>mm</i>
7514894	4
7514896	6
7514898	8
751490	10
751492	12
751494	14
751496	16
751498	18
751500	20
7515022	22
7515024	24
7515028	26-28
7515029	32
75150292	36



Nylonkauser / Nylon eyelet

<i>Art nr</i>	<i>Str / size</i> <i>mm</i>
7513802	8
7513810	10
7513812	12
7513814	14
7513816	16
7513818	18
7513820	20



Strekfisk med gaffel, syrefast / Acid proof turnbuckle

<i>Art nr</i>	<i>Dimensjon</i> <i>mm</i>	<i>Dimensjon</i> <i>tommer / inches</i>	<i>Arb. last /</i> <i>working load</i> <i>kg</i>
751335	5	3/16"	190
751336	6	1/4"	375
751338	8	5/16"	625
751339	9	9/16"	875
751342	12	1/2"	1700



Fenderfeste, syrefast / Acid proof ringplates

<i>Art nr</i>	<i>Str.</i>	<i>Betegnelse /</i> <i>type</i>
752801	Liten	M/mothake/barb
752802	Stor	M/mothake/barb
752803	Liten	Åpen / open



Ringplater, syrefast / Acid proof fender fitting

Art nr	Str.	Betegnelse / type
753624	8	M/bøyle / clamp
753622	8	M/løs ring / loose ring
753623	10	M/løs ring / loose ring

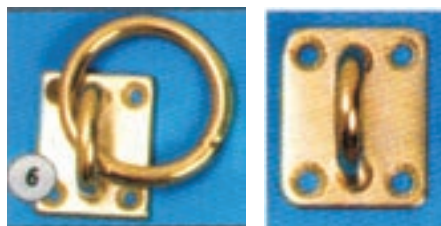

Båtringer med mutter og løs ring / Boat ring with nut and loose ring

Art nr	Str. /size mm
753658	8
753659	9
753662	12

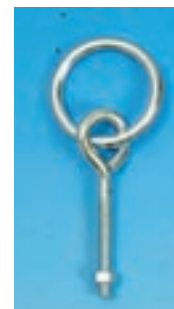

Rustfri D-sjakkell / Acid proof D-shackle

Art nr	Str. / size	Str. / size	Arb. last / working load kg
753298	4	1/8"	188
753299	5	3/16	300
753300	6	1/4	440
753301	8	5/16	750
753302	10	3/8	1450
753303	12	1/2	1750
7533034	14	9&16	2625
753304	16	5/8	3300
753305	20	3/4	5000



Rustfri D-sjakkell med spor, syrefast / Acid proof D-shackle, with countersunk pin

Art nr	Str. / size	Str. / size	Arb. last / working load kg
7533107	7		550



B-sjakkell, syrefast / Acid proof B-shackle

Art nr	Str. / size	Str. / size	Arb. last / working load kg
7533050	6	1/4"	440
7533051	8	5/16	750
7533052	10	3/8	1450
7533053	12	1/2	1750
7533054	14	9/16	2625
7533055	16	5/8	3300



D-sjakkell , syrefast, lang / Acid proof long B-shackle

Art nr	Str. / size	Str. / size	Arb. last / working load kg
75339808	8	5/16"	750
75339810	10	3/8	1450
75339812	12	1/2	1750

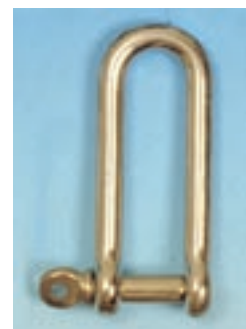

Snappsjakkell med svivel , syrefast / Acid proof snap shackle with swivel

Art nr	Str. / size	Arb. last / working load kg
753516	90	300
753522	125	500



Øyemutter, syrefast / Acid proof eyelet nut

Art nr	Str. / size mm
753706	6
753708	8
753710	10
753712	12



Øyebolt, syrefast / Acid proof eye bolt

Art nr	Str. / size mm
753726	6
753728	8
753730	10
753732	12



Øyebolt med mutter og skiver, syrefast / Acid proof eye bolt with nut and washer

Art nr	Str. / size mm
753758	8
753760	10



Ubolt "slepeplate" med fast øye, syrefast / Acid proof U bolt

Art nr	Str. / size mm
753610	9,5



Sjakkell vridd, syrefast / Acid proof twisted shackle

Art nr	Str. / size mm	Str. / size inches	Arb. last / working load kg
753326	10	3/8"	1450



Skruløkke, syrefast / Acid proof shackle with nut lock

Art nr	Str. / size mm	Str. / size inches	Arb. last / working load kg
753386	6	1/4	812
753388	8	5/16	1375
753390	10	3/8	2250
753392	12	1/2	2750
753394	14	9/16	3875
753396	16	5/8	5000
7533944	14	9/16	300



Svivel, syrefast / Acid proof swivel

Art nr	Str. / size inches	Ø	Arb. last / working load kg
7511305	3/16"	5	205
7511308	5/16"	8	635
7511309	3/8"	10	875

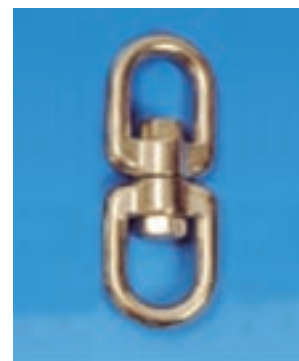

– For større dimensjoner se tidligere dette kapittelet.
For larger dimensions, see items earlier in this chapter.

Wireklemme, syrefast / Acid proof wire rope clip SF 316

Art nr	Str. / size mm
751320	2
751321	3
751322	4
751324	6
751325	8
751326	10
751327	12
751328	14
751329	16



Art nr	Båndbredde / band width mm	Str / size mm
752812	12,7	11-19
752814	12,7	15-24
752820	12,7	30-45
752826	12,7	32-50
752833	12,7	25-51
752852	12,7	60-80



Håvring / Net rings

Art nr	Dimensjon mm	Diameter mm
753203	3	
753205	5	45
753206	6	50
753208	8	55
753209	10	70
75320927	12	75
75320929	12	90
75320947	14	75
75320949	14	90
75320999	19	90
9678105	18	70



Smettløyker DL / Split links

Art. nr.	Betegnelse/ Type	Mål i mm / Measures in mm					Brudd- SWL last tonn tonn	
		A mm	B mm	C mm	D mm	E mm		
753218	DL 18 S	76	44	18	15	50	1,0	0,2
753219	DL 19 S	80	51	24	19	49	2,0	0,4
753220	DL 20 S	83	56	23	18	49	3,0	0,5
753221	DL 21 S	113	65	23	24	70	7,0	1,4
753222	DL 22 S	110	74	33	23	70	6,5	1,3



111

Smettløyker med øye / Split links with eye

Art. nr.	Betegnelse/ Type	Mål i mm / Measures in mm					Brudd- SWL last tonn tonn	
		A mm	B mm	C mm	D mm	E mm		
753226	DL 26 S	150	95	39	28	16	12	2,4
753227	DL 27 S	212	130	58	33	23	25	5,0
753228	DL 28 S	260	163	61	49	29	60	12,0



Smettløyker, syrefast / Acid proof split link

Art nr	Dimensjon mm	Bruddstyrke / breaking load
753211	11	1100
753212	13	1500
753216	16	3000



Briller / Figure of eight

<i>Art nr.</i>	<i>Betengelse / type</i>	<i>Str / size mm</i>	<i>A mm</i>	<i>B mm</i>	<i>Vekt / weight kg</i>
751458	CS 08 SS	10	75	60	44
751459		12	75	60	63

